



The leader in marine systems.

www.imtra.com



508.995.7000

## Side-Power Gearleg Assembly

### *SIDE-POWER THRUSTERS*

Please note that on the Side-Power SP55S, SP75T, and SP95T, it is necessary to install the propeller on the gearleg in the correct fashion. This is covered in the installation manual, but highlighted here. Make sure to slide the propeller over the prop drive pin on the prop shaft. It should snap into place. As illustrated below, the prop must be locked over the drive pin #5 before tightening the locknut #3 over the washer #4.

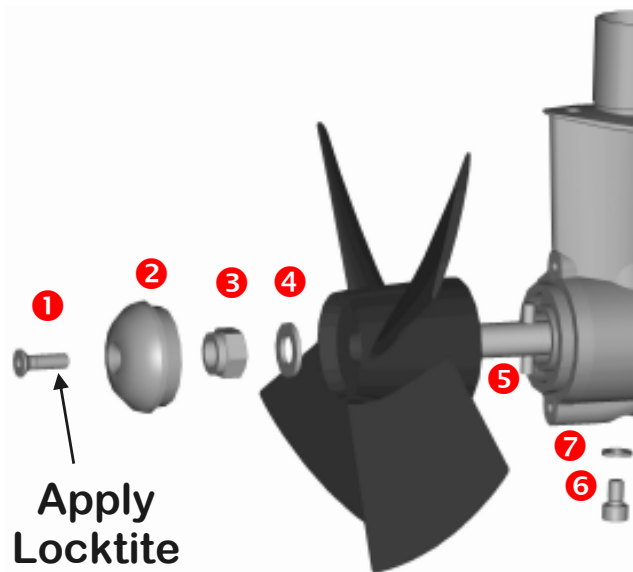

THRUSTERS



MARINE LIGHTING



ANCHORING SYSTEMS



MARINE WIPERS



CUSTOM EQUIPMENT